

Infinity Series Waste Receptacles

35G Front Load Waste Receptacle

Number:

W.INF.WR.035

\$ (FOB Anderson, Indiana)

Key Features:

- Aluminum Tray Powder Coated Gray
- Frame - Powder Coat Gray
- Slats - Cedar Color HDPE
- Surface Mount Required
- EZ Install Base
- Unit ships fully assembled

Note: Liner NOT Included.
Purchase separately from KES

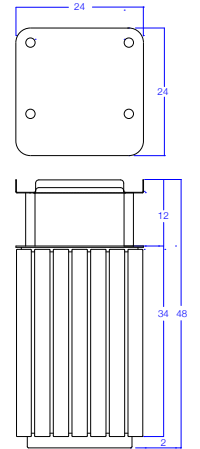
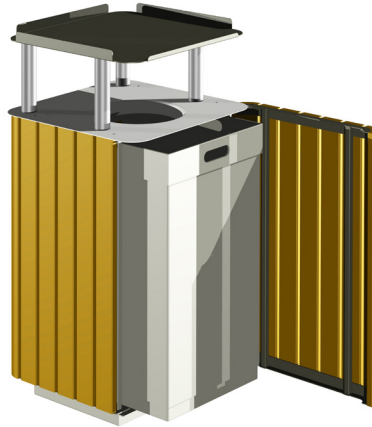

32G Top Load Waste Receptacle

Number:

W.INF.WR.032

\$ (FOB Anderson, Indiana)

Key Features:

- Frame - Powder Coat Gray
- Slats - Cedar Color HDPE
- Surface Mount Required
- EZ Install Base
- Unit ships fully assembled

Note: Liner Included.

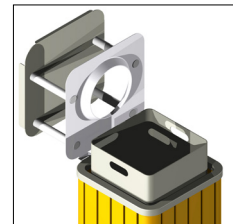
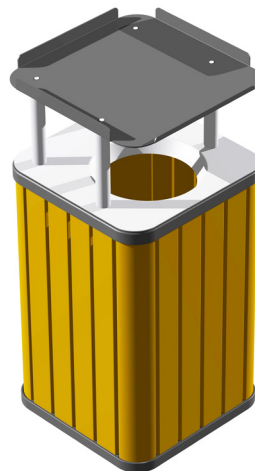

A minimum 14" clear space must be provided for cover to open fully during servicing. The open cover will clear any objects 32" or under. A retainer cable stops the top swing @ about 90 degrees.

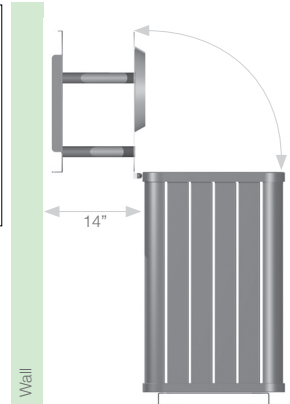

32G Drive-up Waste Receptacle

Number:

W.INF.DB.WR.DR

\$ (FOB Anderson, Indiana)

Key Features:

- Stainless Steel Chute Bottom
- Aluminum Chute Enclosure
- Aluminum Chute Powder Coat Gray
- Aluminum Frame Powder Coat Gray
- Slats - Cedar HDPE
- Self-Latching Top Access Button
- EZ Install Base
- Surface Mount Required
- Unit ships partially assembled

Note: Liner Included

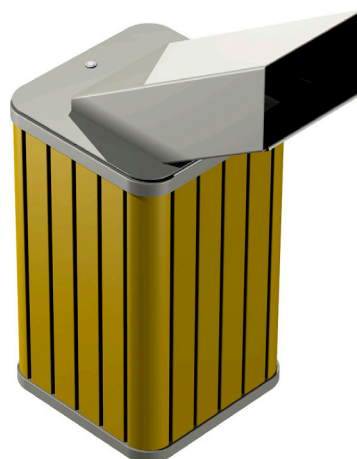

Top shown in "OPEN" position for access to empty trash contents. Chute is vertical when fully open.

